

Fig. 9101



Pressure Temperature Ratings

Working pressure	16bar
Testing Pressure	Shell:24bar
	Seal:17.6bar
Working Temperature	-10 to 100

Material Specification

Part	Material	EN Spec.
Body	Ductile Iron	EN-JS1050
Orifice Cover	Ductile Iron	EN-JS1050
Air Release Nipple	Brass	EN 12165 CW603N
Screw Plug	Brass	EN 12165 CW603N
Float Ball	ABS ISO2580	Commercial
Ball Seal Orifice	EPDM	Commercial

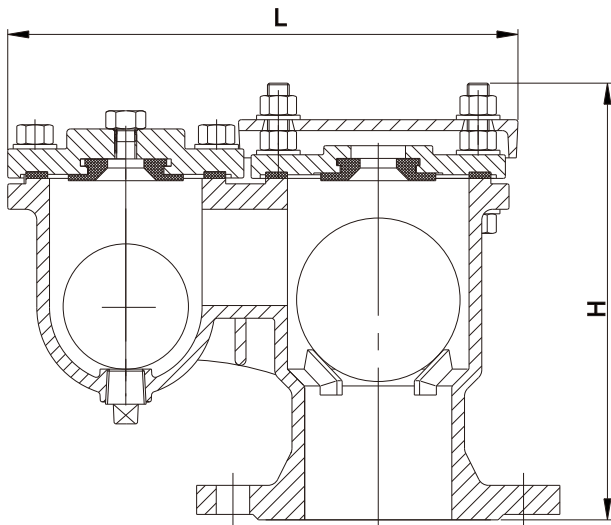

Dimensions

DN	mm	25	40	50	65	80	100	125	150	200	250
	inch	1	1-1/2	2	2-1/2	3	4	5	6	8	10
L		147	224	273	273	283	302	353	353	433	491
H		185	187	214	214	244	270	323	323	401	450